



**5 - 7 Beds**

**5.5 - 7 Baths**

**5,520 - 8,536 Sq Ft**

**COMMUNITY CONTACT**

15600 BENNINGTON FARMS LANE (GPS:  
 16428 BALD EAGLE SCHOOL RD)  
 BRANDYWINE, MD 20613  
 NONE  
 NONE

Introducing our newest estate plan, the Aspen. This stunning home offers luxurious living on a grand scale. With up to 8,536 square feet of living space and up to 7 bedrooms, this home has everything you could want for your entire family, including options to make this a multi-generational home.

The home offers fabulous curb-appeal with a large covered porch, perfect for relaxing and enjoying the outdoors, and options for a 2-car or 3-car garage. Inside, you'll find a spacious open floor plan with a two-story great room open to a gorgeous kitchen with a huge center island for entertaining. The included 1st floor in-law suite provides a comfortable space for guests or family members. A 1st floor extension offers a true multi-generational living space with a separate entrance, living area, bedroom and bath for added privacy.

Upstairs features an open loft area for lounging and four bedrooms, each with a private bath and walk-in closet. The owner's suite is a true retreat with the option to upgrade to a luxurious deluxe bath with walk-thru shower. Design the basement of your dreams for entertaining and family fun. With options such as a recreation area, hobby area, den, or media room - the possibilities ...

## Available Elevations



## BASEMENT

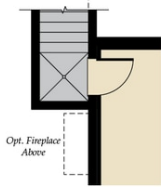

OPT. SINGLE AREAWAY

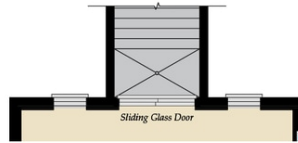

OPT. DOUBLE AREAWAY



OPT. WALKOUT BASEMENT

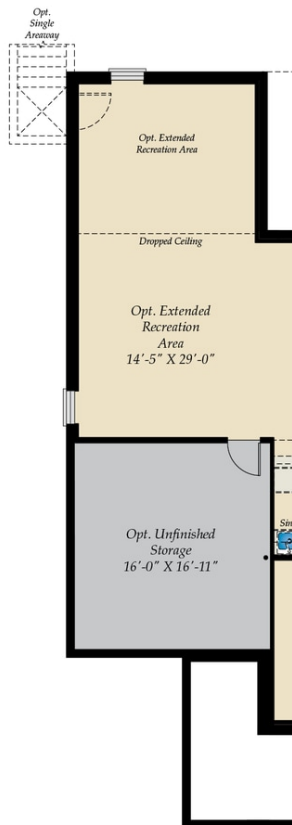

OPT. MULTI-GEN  
SUITE ABOVE



OPT. FINISHED BASEMENT

## FIRST FLOOR

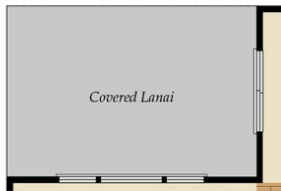

OPT. COVERED LANAI



OPT. 3RD CAR GARAGE  
SIDE LOAD

