



4 - 5 Beds

4.5 - 5 Baths

3,494 - 5,700 Sq Ft

The Statesville is a 5 bedroom, 4.5 bath home with the Owner's suite upstairs along with 3 additional bedrooms and 2 baths. Open family room, gourmet kitchen, drop zone, formal dining with optional Butler pantry and 2 story foyer.

Available Elevations



Brick/stone fronts, chimneys, bay windows, keystones, exterior trim, garage doors, light fixtures, dormers, and gables shown on elevations are optional features. Actual product specifications may vary in dimension or detail from these drawings. This insert is for illustrative purposes only and is not part of the legal contract. All dimensions are approximate. Many available options are not shown.

FIRST FLOOR



Brick/stone fronts, chimneys, bay windows, keystones, exterior trim, garage doors, light fixtures, dormers, and gables shown on elevations are optional features. Actual product specifications may vary in dimension or detail from these drawings. This insert is for illustrative purposes only and is not part of the legal contract. All dimensions are approximate. Many available options are not shown.

SECOND FLOOR

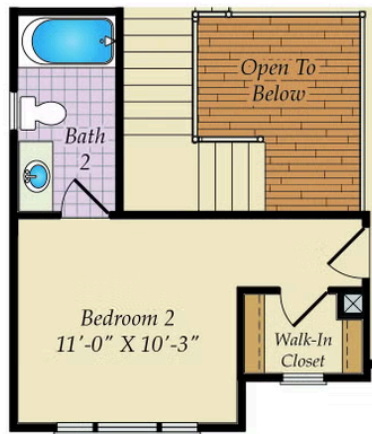

BEDROOM 2 WITH BATHROOM 2

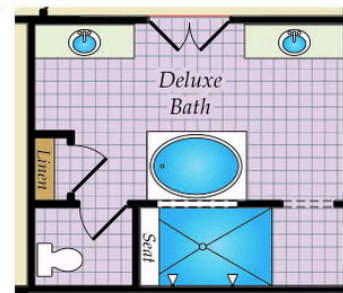

OPT. DELUXE BATH

OPTIONAL BASEMENT



FIRST FLOOR BASEMENT STAIRS



Brick/stone fronts, chimneys, bay windows, keystones, exterior trim, garage doors, light fixtures, dormers, and gables shown on elevations are optional features. Actual product specifications may vary in dimension or detail from these drawings. This insert is for illustrative purposes only and is not part of the legal contract. All dimensions are approximate. Many available options are not shown.

OPTIONAL THIRD FLOOR

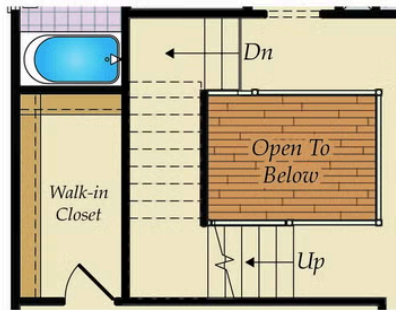

STAIRS ON SECOND FLOOR
W/ OPT. THIRD FLOOR

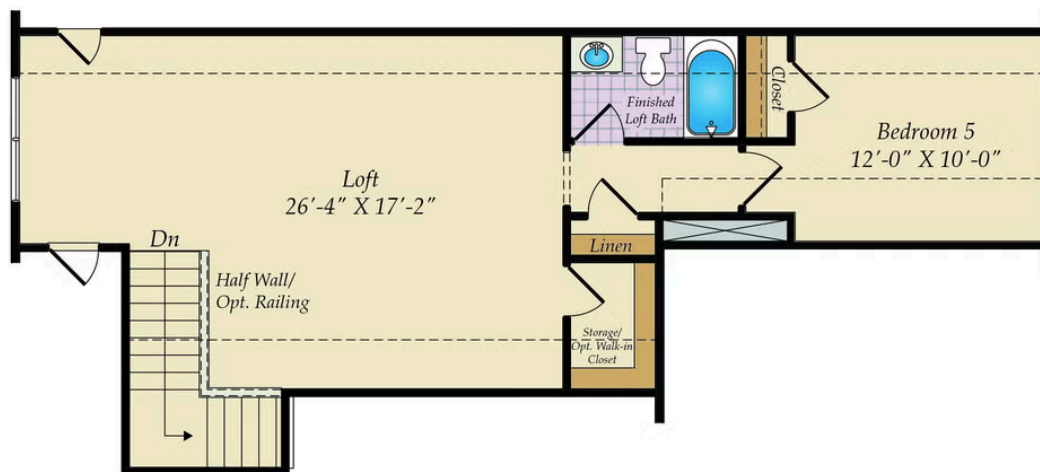

OPTIONAL THIRD FLOOR

Brick/stone fronts, chimneys, bay windows, keystones, exterior trim, garage doors, light fixtures, dormers, and gables shown on elevations are optional features. Actual product specifications may vary in dimension or detail from these drawings. This insert is for illustrative purposes only and is not part of the legal contract. All dimensions are approximate. Many available options are not shown.