



Single Family

Priced From

\$1,129,990

4 - 5 Beds

2.5 - 6.5 Baths

4,554 - 8,162 Sq Ft

COMMUNITY CONTACT

15600 BENNINGTON FARMS LANE (GPS:
16428 BALD EAGLE SCHOOL RD)
BRANDYWINE, MD 20613
NONE
NONE

The Monticello plan is a gorgeous estate home starting at 4,650 square feet, with options to expand up to 7,610 square feet of elegant living space. The home can be built with a two or three car garage and is available in many elevations, including brick and stone combination fronts. Inside, this home is loaded with luxury including a grand two-story foyer, a spacious kitchen and multiple additions such as a morning room and conservatory. Retreat to the owner's suite where you can enjoy a sitting area with optional fireplace, a dreamy his & her walk-in closet and an opulent spa bath with the option to add an exercise room. This basement is ready for fun and entertainment when you add options such as a rec room, theater room, wet bar and a den or 5th bedroom. There are endless ways to personalize this luxurious home with your own unique style.

Available Elevations



Elevation 1



Elevation 2



Elevation 3A

BASEMENT

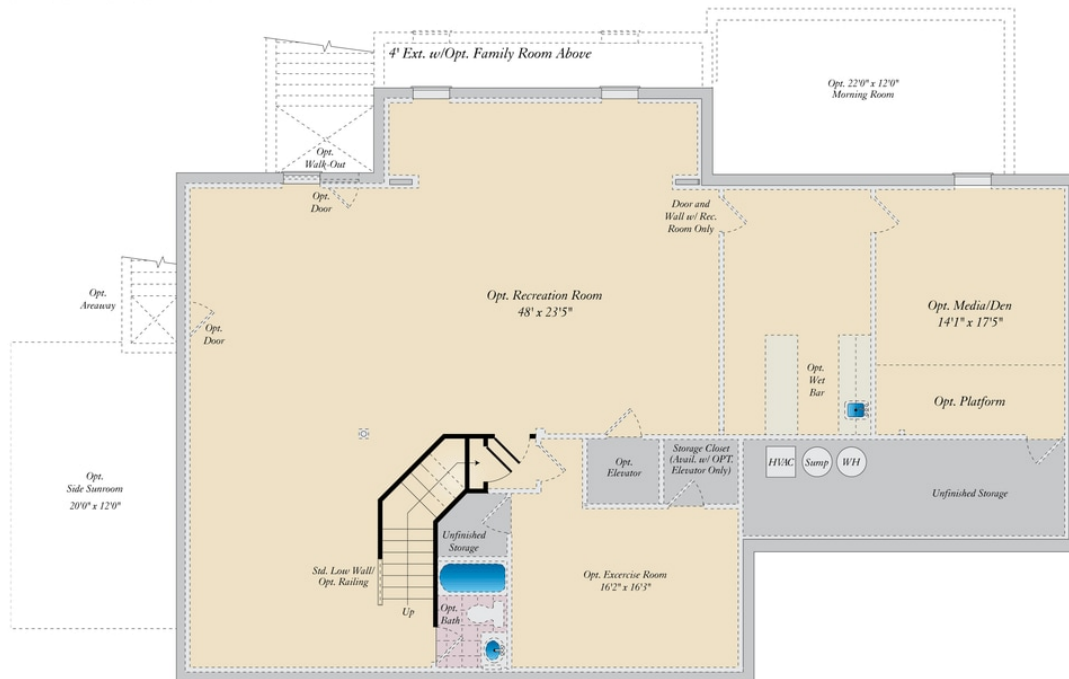

FIRST FLOOR

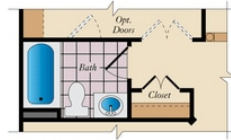

OPT. FULL BATH

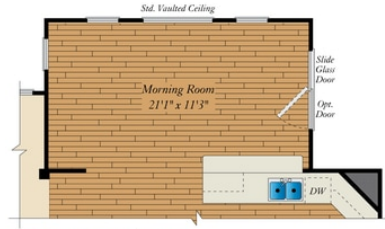

OPT. MORNING ROOM



OPT. CONSERVATORY

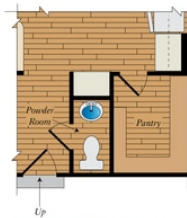

OPT. POWDER ROOM

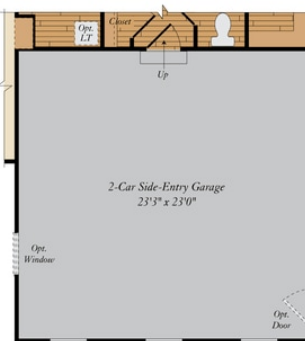

OPT. 3-CAR SIDE-ENTRY GARAGE

SECOND FLOOR

